

# PERIODISK VEDLIGEHOLD

## IMOP 40 PRO



For service og support

51 71 44 06

service@virena.dk



Følg først alle trin i den daglige vedligehold.

*Follow all steps in the daily maintenance.*



Rens snavsevanstanken med rent vand og børste.

*Clean the dirty water tank with clean water.*



Skrue filteret i bunden af rentvandstanken ud.

*Unscrew the filter at the bottom of the clean water tank.*



Rens filteret med vand og børste. – evt. afkalk.

*Clean the filter with water and a brush – if needed, descale.*



Afmonter sugeslangen i bunden af maskinen.

*Remove the suction hose at the bottom of the machine.*



Frigør sugeslangen fra magneten i toppen.

*Release the suction hose from the magnet at the top.*



Skrue enderne af slangen – drej modsat

*Unscrew the ends of the hose – turn counter*

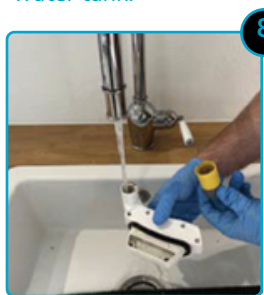

Rens endestykkerne med vand – evt. med børste.

*Clean the end pieces with water – and optionally a brush.*

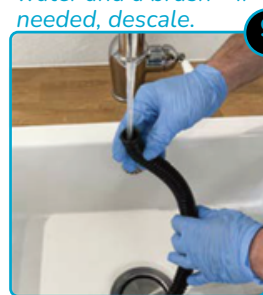

Skyl sugeslangen grundigt med vand.

*Rinse the suction hose thoroughly with water.*

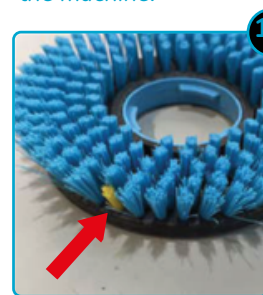

Skift børste, når den er slidt ned til det gule.

*Replace brush when it's worn down to yellow.*

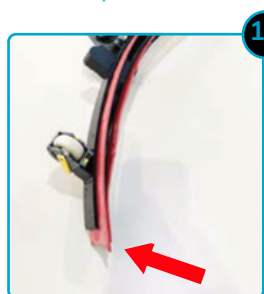

Tjek sugegummi og hjul for slid og hår.

*Check squeegee rubber and wheels for wear and hair.*



Udtag flydespærren.

*Remove the float cage.*

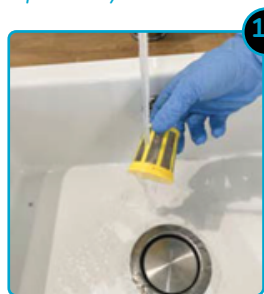

Skyl flydespærren i vand.

*Rinse the float cage with water.*



Saml maskinen og parkér i opret position.

*Reassemble the machine and park it upright.*

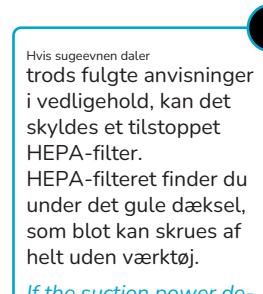

Hvis sugeevnen daler trods fulgte anvisninger i vedligehold, kan det skyldes et tilstoppet HEPA-filter. HEPA-filteret finder du under det gule dæksel, som blot kan skrues af helt uden værktøj.

*If the suction power decreases despite following the maintenance instructions, it may be due to a clogged HEPA filter. You can find the HEPA filter under the yellow cover, which can easily be unscrewed without any tools.*